



REF: # 10744



#### INFO

**PRICE:** 129.800 €

**PROPERTY TYPE:** Apartment

**LOCATION:**

**BEDROOMS:** 3

**Bathrooms:** 2

**Build:** 130 (m2)

**Plot:** -

**Terrace:** -

**Year:** -

**Floor:** -

**Old price** -



#### DESCRIPTION

FANTASTIC GROUND FLOOR APARTMENT IN THE CENTRE OF SAN PEDRO DEL PINATAR - less than 1km from the beach! This 100m2 ground floor apartment in an exclusive residential complex, which is superbly located just 10 minutes from the beach, the Town Hall and on the road that leads to the famous Lo Pagan curve. The property consists of 3 bedrooms, 2 bathrooms, open plan kitchen / dining area and 5m2 terrace private terrace. San Pedro del Pinatar is a municipality on the coast of Murcia which is situated on the Mar Menor and is connected to the whole country via the AP-7 motorway and to the main European capitals via Alicante airport, 45 minutes away. San Pedro del Pinatar has everything to live at ease: the calm of the port and the sea, the healthy embrace of La Laguna, the proximity to all services and the joy of the curve of Lo Pagán. Only a 30 minute drive from Murcia (Covera) Airport.

<b>STYLE</b>	<b>VIEWS</b>	<b>DISTANCE TO :</b>	<b>FURNITURE</b>
<ul style="list-style-type: none"><li>• Modern</li></ul>	<ul style="list-style-type: none"><li>• Panoramic views</li></ul>	Beach : 1 Km Airport: 40 Km	<ul style="list-style-type: none"><li>• Not furnished</li></ul>
<b>FLOORING</b>	<b>KITCHEN</b>	<b>GARDEN AND TERRACES</b>	<b>HEATING</b>
<ul style="list-style-type: none"><li>• Tile floors</li><li>• Stone floors</li></ul>	<ul style="list-style-type: none"><li>• Open kitchen</li></ul>	<ul style="list-style-type: none"><li>• Open terrace</li></ul>	<ul style="list-style-type: none"><li>• Central gas heating</li></ul>
<b>EXTRA</b>			
<ul style="list-style-type: none"><li>• Built in wardrobes</li><li>• Reinforced door</li><li>• Double glazed windows</li></ul>			











































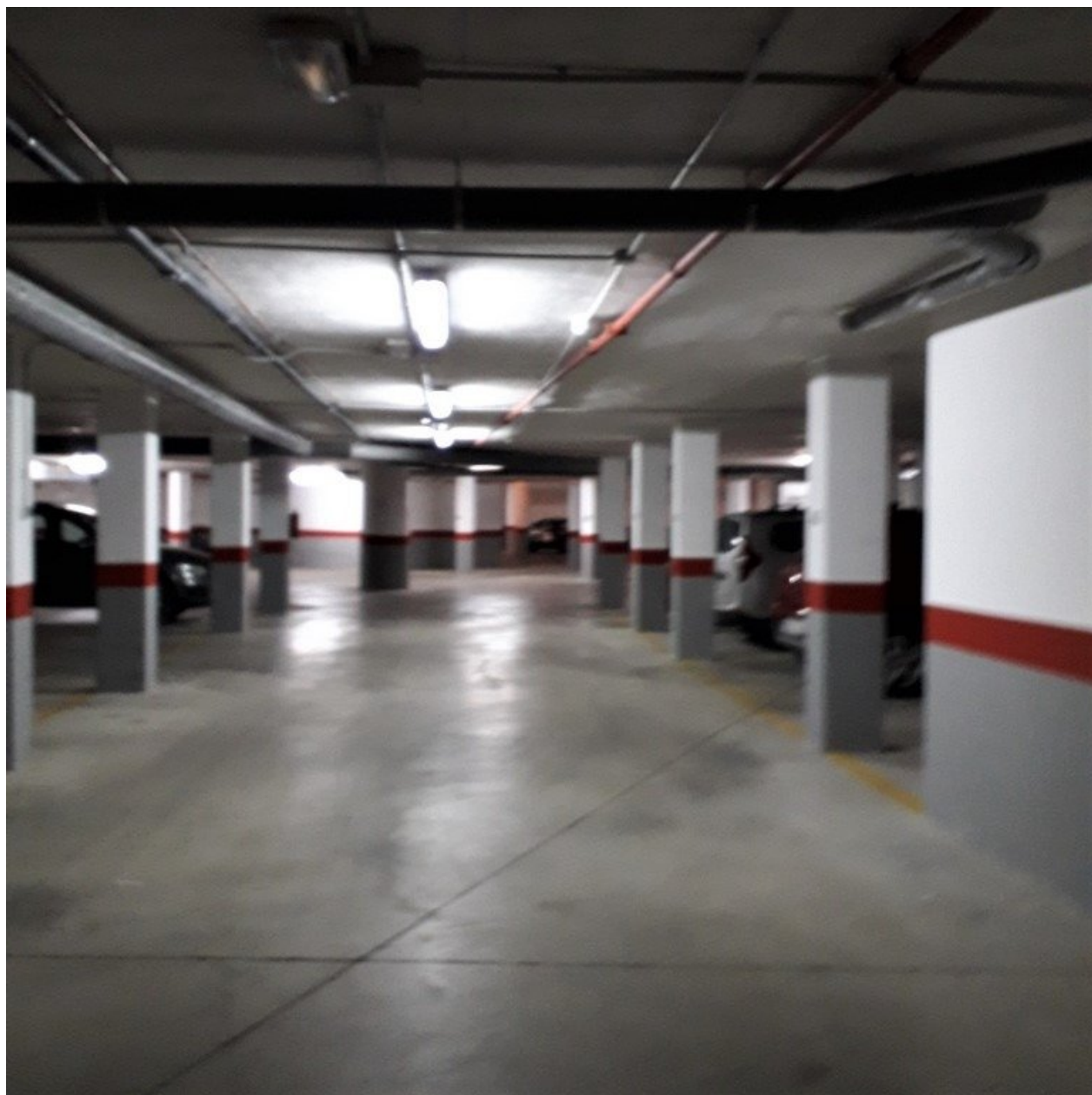

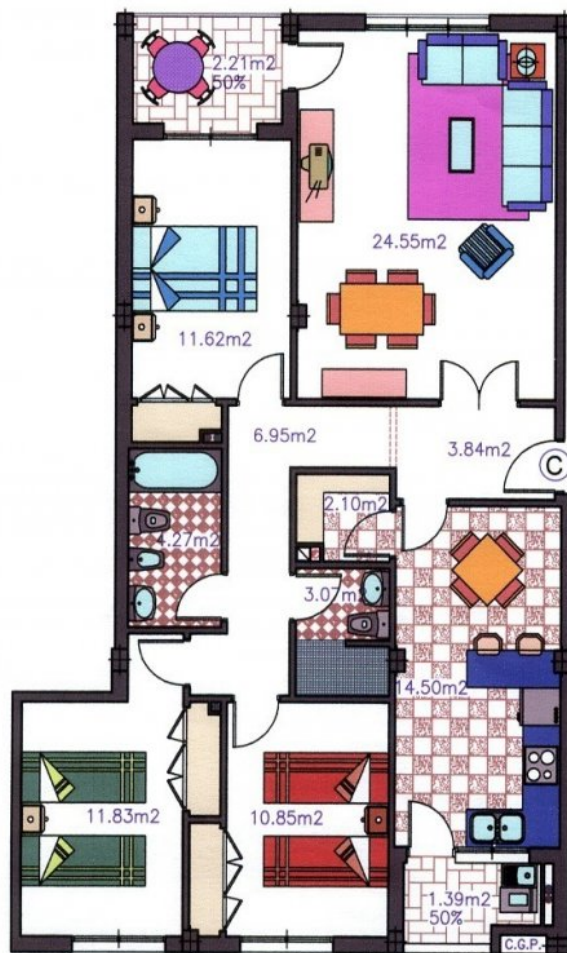

Planta Baja

Escalera -2-	Vivienda -C-	3 dormitorios
Sup. Construida =	109,40m <sup>2</sup>	
Sup. P.P.S.C..... =	17,65m <sup>2</sup>	
Total Construida =	127,05m <sup>2</sup>	
Sup. Util..... =	97,18m <sup>2</sup>	

Escala — 1:100

*"Experience our experience - Because you deserve the best"*