



REF: # 11382



INFO

PRICE: 370.000 €

PROPERTY TYPE: Apartment

LOCATION:

BEDROOMS: 3

Bathrooms: 2

Build: 82 (m2)

Plot: 170 (m2)

Terrace: 18 (m2)

Year: -

Floor: -

Old price -



DESCRIPTION

WONDERFUL NEW BUILD RESIDENTIAL COMPLEX OF APARTMENTS, GROUND FLOOR, IN PUNTA PRIMA, ORIHUELA COSTA only a few meters from the centre. This new ground floor 82m2 apartment consists of 3 bedrooms, 2 bathrooms a 18m2 terrace, parking and a large 170m2 private garden. The complex will offer nice green areas with a playground for children, a gym and two communal pools. It is located just a few meters from the centre of Punta Prima where you will find all the amenities you may need; nice restaurants, cafes, supermarkets, pharmacies and more. Punta Prima is located just 5 km from Torrevieja and has a good health infrastructure and a plenty of services available throughout the year. Just 10 km away we can find the golf courses of Villamartín, Campoamor, Las Ramblas, Las Colinas and Lo Romero, as well as the commercial centres of La Zenia and Habaneras. Nearest Airports: Alicante Airport 45mins drive (70km) and Murcia (Corvera) 42 mins (58km).

STYLE <ul style="list-style-type: none">• Modern	VIEWS <ul style="list-style-type: none">• Panoramic views	AIRCONDITIONING <ul style="list-style-type: none">• Central airconditioning	DISTANCE TO : <div>Beach : 3 Km</div> <div>Airport: 60 Km</div>
FURNITURE <ul style="list-style-type: none">• Not furnished	PARKING <div>Parking no Cars: 1</div>	MAIN LIVING AREA <ul style="list-style-type: none">• Bathroom en-suite• Gym	KITCHEN <ul style="list-style-type: none">• Open kitchen
GARDEN AND TERRACES <ul style="list-style-type: none">• Open terrace• Play Ground• Landscaped• Fenced• Private garden• Communal Garden	EXTRA <ul style="list-style-type: none">• Built in wardrobes• Reinforced door• Double glazed windows• Lift		























WIENHA 3 DORMITORIOS	Superficie m ² p ²
PLANTA BAJA	m ²
Sala-Cocina-Cuarto	29.15
Cuarto	1.32
Dormitorio 1	10.41
Baño 1	3.43
Baño 2	4.38
Dormitorio 2	9.25
Dormitorio 3	10.27
Pórtico	17.50
SUPERFICIE ÚTIL TOTAL	84.72m ²
SUPERFICIE CONSTRUIDA TOTAL	83.75m ²

MODELO 3 DORMITORIOS



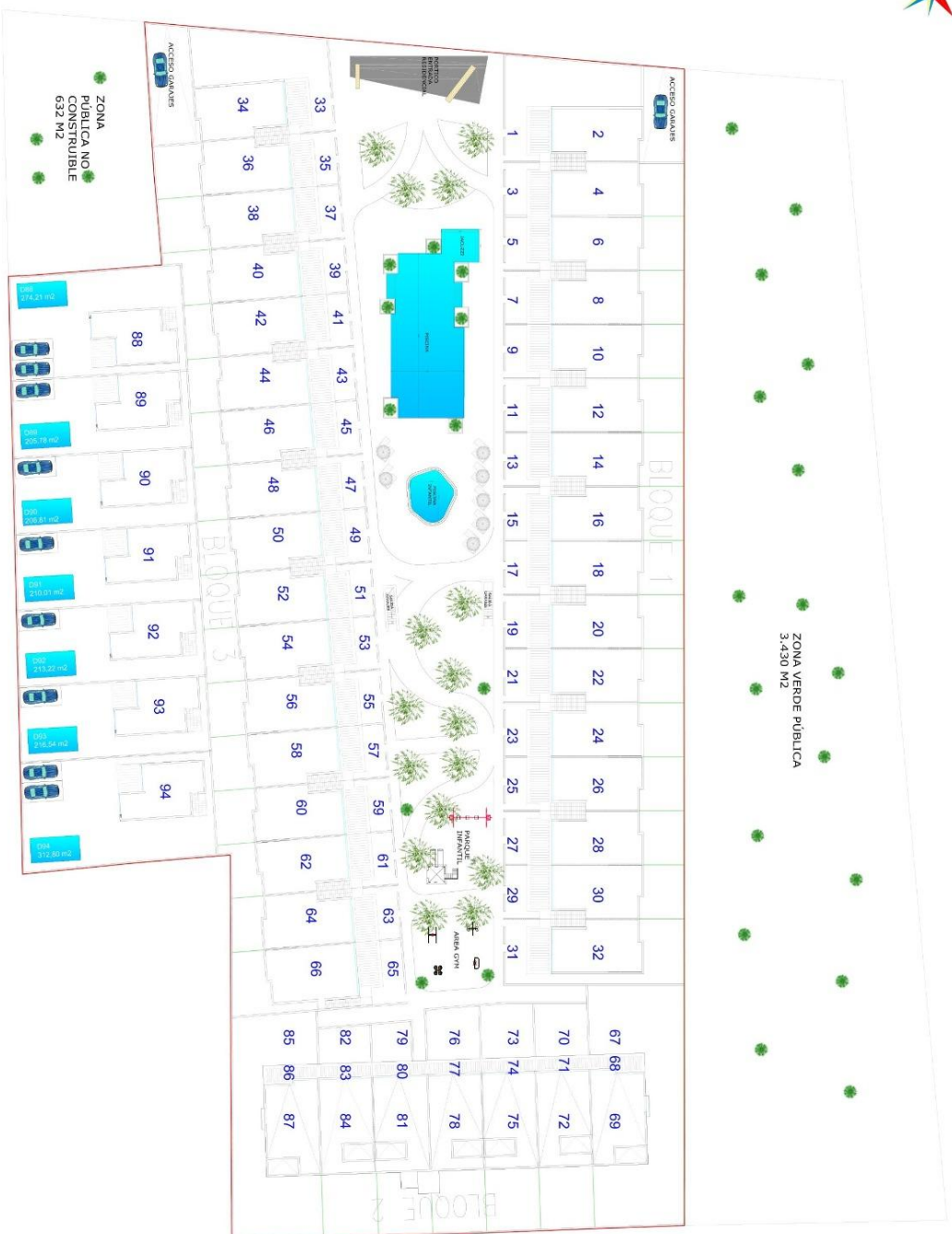







"Experience our experience - Because you deserve the best"