



REF: # 3932



INFO

PRICE:	169.900 €
PROPERTY TYPE:	Apartment
LOCATION:	
BEDROOMS:	2
Bathrooms:	2
Build:	75 (m2)
Plot:	-
Terrace:	75 + 24 (m2)
Year:	
Floor:	2
Old price	-

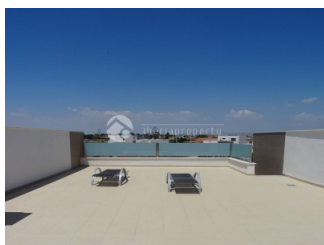

DESCRIPTION

Fantastic beautiful apartments only 700 meters from the sandy beach of San Pedro del Pinatar and very short distance to several shops and restaurants. This is one of the best deals for a holiday in Spain. The apartment consists of 2 bedrooms and 2 bathrooms. Large and open living room with ultramodern kitchen. Several terraces. Private Terrace throughout 75m.2 and a large terrace of 24 m2 with access from both bedrooms. Walking distance to everything. Finished installing the outdoor kitchen on the roof terrace. It is only used building materials in very high quality. Security door, double windows very well insulated.

STYLE <ul style="list-style-type: none">• Modern	AIRCONDITIONING <ul style="list-style-type: none">• Central airconditioning	DISTANCE TO : <div>Beach : 500 m</div> <div>Airport: 20 Km</div> <div>Town center : 200 m</div>	ORIENTATION <div>South</div>
FURNITURE <ul style="list-style-type: none">• Not furnished	PARKING <div>Garage no Cars : 1</div> <div>Parking no Cars: 1</div>	FLOORING <ul style="list-style-type: none">• Tile floors	KITCHEN <ul style="list-style-type: none">• Open kitchen• Equipped kitchen
GARDEN AND TERRACES <ul style="list-style-type: none">• Covered terrace• Open terrace• Exterior lights• Palm trees• Fenced• Stone walls• Outdoor kitchen• Communal Garden	HEATING <ul style="list-style-type: none">• Central electric heating	EXTRA <ul style="list-style-type: none">• Built in wardrobes• Double glazed windows• Door bell with camera• Laundry room• Internet	

















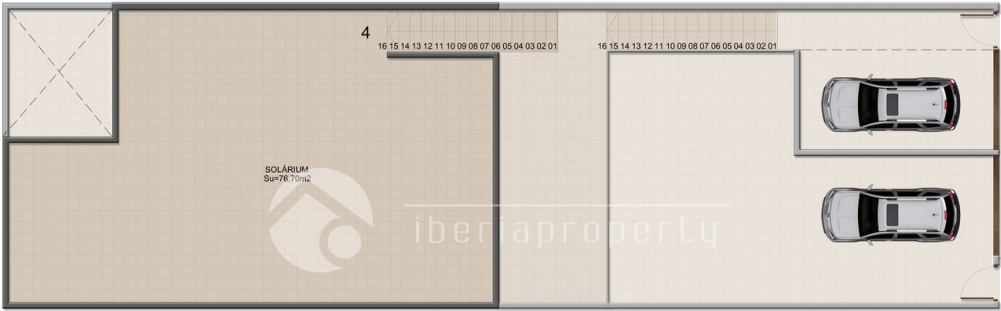

CUADRO DE SUPERFICIES				
Vivienda	Planta.	Uso.	S. Útil.	S. Const.
4	Primera.	Vivienda.	65.30 m2	75.42 m2
		Lavadero.	2.60 m2	2.60 m2
		Terraza.	23.95 m2	23.95 m2
		Solarium.	76.70 m2	76.70 m2
	Total m2.		168.55 m2	178.67 m2

VIVIENDA 4
PLANTA PRIMERA
ESCALA:1/75

PLAYAMAR III



CUADRO DE SUPERFICIES

Vivienda	Planta.	Uso.	S. Útil.	S. Const.
4	Primera.	Vivienda.	65.30 m²	75.42 m²
		Lavadero.	2.60 m²	2.60 m²
		Terraza.	23.95 m²	23.95 m²
		Solarium.	76.70 m²	76.70 m²
		Total m².	168.55 m²	178.67 m²

VIVIENDA 4
PLANTA PRIMERA
ESCALA: 1/75

PLAYAMAR III

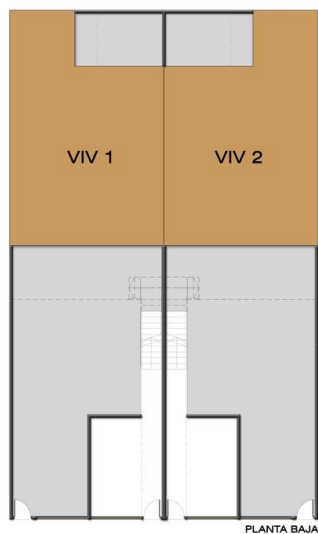

PLANTA BAJA

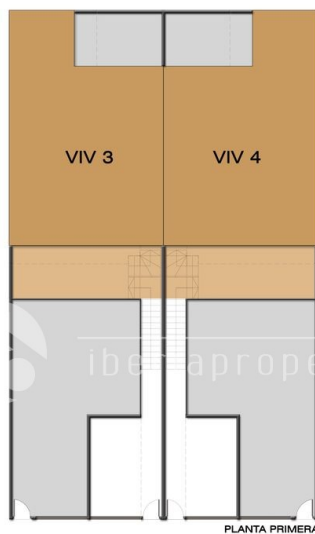

PLANTA PRIMERA

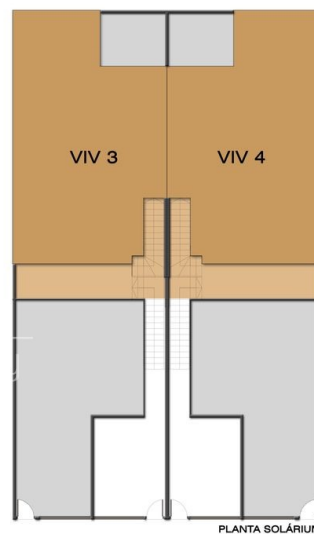

PLANTA SOLARIUM

PLAYAMAR III

"Experience our experience - Because you deserve the best"