



**In Sun
Properties Spain**
since 1999

REF: # 9722



INFO

PRICE: 259.900 €

PROPERTY TYPE: Apartment

LOCATION:

BEDROOMS: 2

Bathrooms: 2

Build: 70 (m2)

Plot: -

Terrace: 68 (m2)

Year: -

Floor: -

Old price -



DESCRIPTION

NEW BUILD RESIDENTIAL OF APARTMENTS 2 BED TOP FLOOR IN PILAR DE LA HORADADA. This 70m2 top floor apartment consists of 2 bedrooms, 2 bathrooms with a private 10m2 terrace and 58m2 solarium. The residential has a communal pool and parking space. They are a relaxing combination of natural materials and extensive decoration and perfectly located close to all services, only 300 meters from the town centre of Pilar de la Horadada and less than 3 kilometres from the beach, in the heart of the Costa Blanca. Pilar de la Horadada is a typical Spanish village in the most southern part of the Costa Blanca. There are the beautiful beaches of Torre de la Horadada and Mil Palmeras with fine sand promenade just 5 minutes away. The large main street has supermarkets, lots of shops, restaurants and bars and some lovely squares. Nearby you have a much larger shopping centre, the Plaza Nueva and internationally recognized golf courses such as Lo Romero, Campoamor and Villamartín, among others. The airports of Corvera (Murcia) and Alicante are respectively 40 and 55 minutes away.

STYLE	VIEWS	AIRCONDITIONING	DISTANCE TO :
<ul style="list-style-type: none">Modern	<ul style="list-style-type: none">Panoramic views	<ul style="list-style-type: none">Central airconditioning	Beach : 3 Km
PARKING	GARDEN AND TERRACES		Airport: 60 Km
Parking no Cars: 1	<ul style="list-style-type: none">Open terraceLandscapedFenced		











Planta primera / First Floor



Planta solarium/ Topfloor

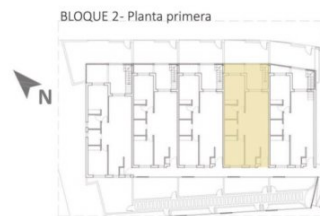

VIVIENDA BLOQUE 2 - 37G:

SUPERFICIE ÚTIL	
Salón - Comedor - Cocina.....	32.47 m²
Dormitorio 1	11.04 m²
Dormitorio 2.....	10.08 m²
Baño 1	3.05 m²
Baño 2	3.38 m²
TOTAL SUPERFICIE ÚTIL	60.02 m²
EXTERIORES	
Terraza	10.80 m²
Solarium.....	58.21 m²
SUPERFICIES CONSTRUIDAS	
Superficie construida vivienda	70.06 m²
TOTAL SUPERFICIE CONSTRUÍDA	70.06 m²

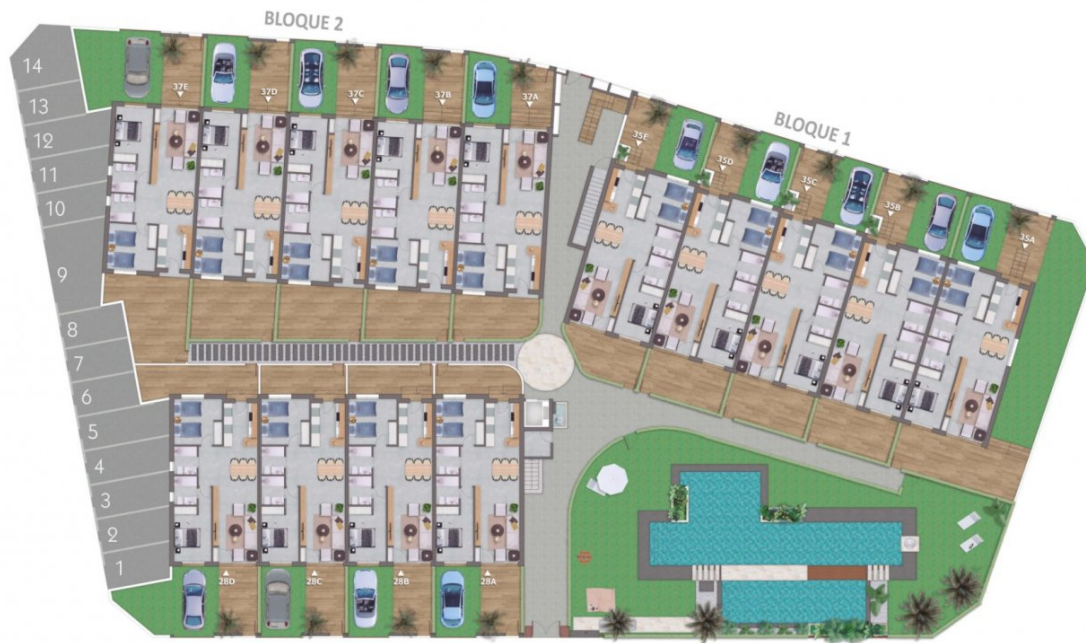

Planta Baja / Ground Floor



Planta Primera / First Floor



Planta Solarium / Topfloor





"Experience our experience - Because you deserve the best"