



REF: # 9759

()



INFO

PRICE:	312.000 €
PROPERTY TYPE:	Penthouse
LOCATION:	()
BEDROOMS:	2
Bathrooms:	2
Build:	108 (m2)
Plot:	-
Terrace:	38 (m2)
Year:	-
Floor:	-
Old price	-

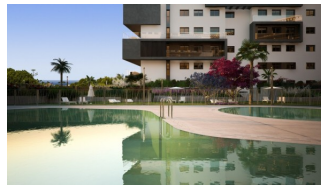
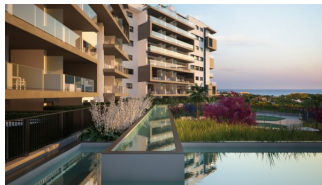
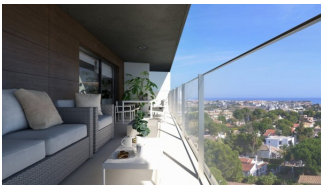

DESCRIPTION

NEW LUXURY RESIDENTIAL APARTMENTS PENTHOUSE IN CAMPOAMOR close to the sea. This 108m2 penthouse apartment consists of 2 bedrooms, 2 bathrooms with a large 38m2 private terrace, and a kitchen equipped with modern appliances. The Residential is located in the highest part of Campoamor, very close to La Glea beach and the marina. Residents will enjoy spacious terraces, ocean and nature views, and beautiful ornamental gardens. Its imposing façade, the balance of its forms, the garden inside it and the huge terraces of the houses make this residential a beautiful architectural landmark in the Mediterranean. A home where you can live the life you have always dreamed of with the most beautiful horizon in the background: the Mediterranean. A contemporary and modern architectural design that offers exclusive homes with top quality finishes, merging spaciousness and new technologies in terms of efficiency and construction. Living in this residential is to feel the Mediterranean in each room of the house. Imagine a place where the sea and nature become the protagonists of an incredible story: yours. Imagine an environment where you can unleash your imagination and live a thousand adventures by land sea. The common areas have been designed for the whole family to enjoy . You can count on green areas to walk and sunbathe. In the common areas there is a large indoor heated pool, a chill out space on the roof, as well as the sports area to enjoy outdoor exercise, a gym, children's play area and a large outdoor pool next to a smaller one for children and a gourmet room. And since we know that you will love taking bike rides in the area, we have reserved a space to store your bikes. Residents will enjoy a fully accessible premium residential for people with reduced mobility and with the guarantee of living in a space protected by private security. Just 1000 m from the beach and a short drive (apx 6km) from shopping centers, famous golf courses, restaurants with exquisite cuisine and large cities such as Alicante or Murcia 1 hour away.

And all this in a climate with 300 days of sunshine a year and an average annual temperature of almost 20°C.
The perfect place for your holidays or to establish your permanent residence.

STYLE	VIEWS	DISTANCE TO :	MAIN LIVING AREA
<ul style="list-style-type: none">• Modern• Contemporary	<ul style="list-style-type: none">• Panoramic views• Sea views	Beach : 1 Km <hr/> Airport: 60 Km <hr/>	<ul style="list-style-type: none">• Gym
KITCHEN	GARDEN AND TERRACES		
<ul style="list-style-type: none">• Equipped kitchen	<ul style="list-style-type: none">• Open terrace• Play Ground• Landscaped• Communal Garden		





















Bloque 1 Escalera 2 Planta 7 Vivienda A

TOTAL SUP. ÚTIL / LIVING AREA:

Sup. útil de vivienda / Property:

Sup. útil de terrazas cubiertas / Terrace covered:

Sup. útil de terrazas descubiertas / Terrace noncovered:

Sup. útil de jardín / garden:

TOTAL SUP. CONSTRUIDA / BUILD AREA:

132.20 m².

72.31 m².

0.00 m².

59.89 m².

0.00 m².

97.40 m².

Escala Gráfica



PLANOS COMERCIALES: Superficies, medidas, configuración, lindes y demás, son los previstos, sujetos a posibles modificaciones por exigencias técnicas, jurídicas o comerciales. No se incluye en el precio ni bienes muebles, ni elementos de jardinería.
COMMERCIAL PLANS: Surfaces, measurements, configuration, boundaries and others are those foreseen, subject to possible modifications due to technical, legal or commercial requirements. Furniture and gardening items are not included in the price.



"Experience our experience - Because you deserve the best"