



REF: # 12513

()



#### INFO

**PRICE:** 430.000 €

**PROPERTY TYPE:** Apartment

**LOCATION:** ()

**BEDROOMS:** 2

**Bathrooms:** 1

**Build:** 82 (m2)

**Plot:** -

**Terrace:** 9 (m2)

**Year:** -

**Floor:** -

**Old price** -



#### DESCRIPTION

**NEW BUILD FRONTLINE RESIDENTIAL IN SAN PEDRO DEL PINATAR** Nestled along the captivating Mar Menor, Lo Pagan is a town in Murcia that unveils a seamless blend of natural beauty and cultural richness, offering a perfect escape for those seeking a tranquil oasis. Conveniently accessible, with just a 57-minute ride from Alicante Airport, Lo Pagan beckons you to unwind, explore, and create cherished memories in this idyllic Spanish coastal town. Indulge in the epitome of refined living with our meticulously crafted New Build residence offering 1, 2, and 3-bedrooms penthouses and apartments. Impeccably designed, the 21 units are gracefully distributed across 3-level blocks. The living space in each unit designed to embrace natural light and create bright, spacious, and modern living areas that seamlessly blend with the coastal surroundings. Explore a variety of residences, available in three different models and sizes. Residential invites you to experience a lifestyle of unparalleled luxury with an array of exquisite amenities: Immerse yourself in the refreshing waters of the communal swimming pool. Enjoy the convenience and security of underground parking. Elevate your leisure time on the shared rooftop terrace. Some of the property has private terraces. Six penthouses on the 2nd floor have a unique feature-direct access to their private solarium through their terraces. Also includes a storage place for added convenience. Additionally, residents have the option to enhance their outdoor experience by adding a summer kitchen to their private solarium. Each home coming is designed to make you feel like you're stepping into a perpetual vacation, a sanctuary where tranquillity meets sophistication. Some properties have a front sea view, some of properties have a side view. San Pedro del Pinatar's privileged location on the Mar

Menor and Mediterranean coastline it attracts those with an interest in sailing and watersports, providing marina mooring and sailing clubs, while the beaches and natural mud baths attract those seeking safe sun, sea and sand. San Pedro del Pinatar has an established community and offers an excellent range of activities, including covered swimming pool and sports facilities, as well as a year round programme of social activities by the pleasant winter weather. The benefits of the mud baths, typical of the region, or the calm waters of the Mar Menor, have favoured the growth of Lo Pagán, which currently has all kind of amenities. In addition, it has an excellent location, just 5 minutes from the Commercial Centre Dos Mares. Murcia/Corvera airport is 30 minutes away and Alicante airport is an hour drive away.

## VIEWS

- Panoramic views
- Sea views

## AIRCONDITIONING

- Central airconditioning

## GARDEN AND TERRACES

- Fenced

## EXTRA

- Lift



PROPERTY GALLERY





















**Planta primera**  
**Vivienda D**

- 1 Sal6n-comedor-cocina
- 2 Vestibulo
- 3 Ba6o
- 4 Dormitorio 1
- 5 Dormitorio 2
- 6 Paso
- 7 Terraza

Sup. total 6til: 73.81 m<sup>2</sup>  
Sup. total construida: 82.77 m<sup>2</sup>

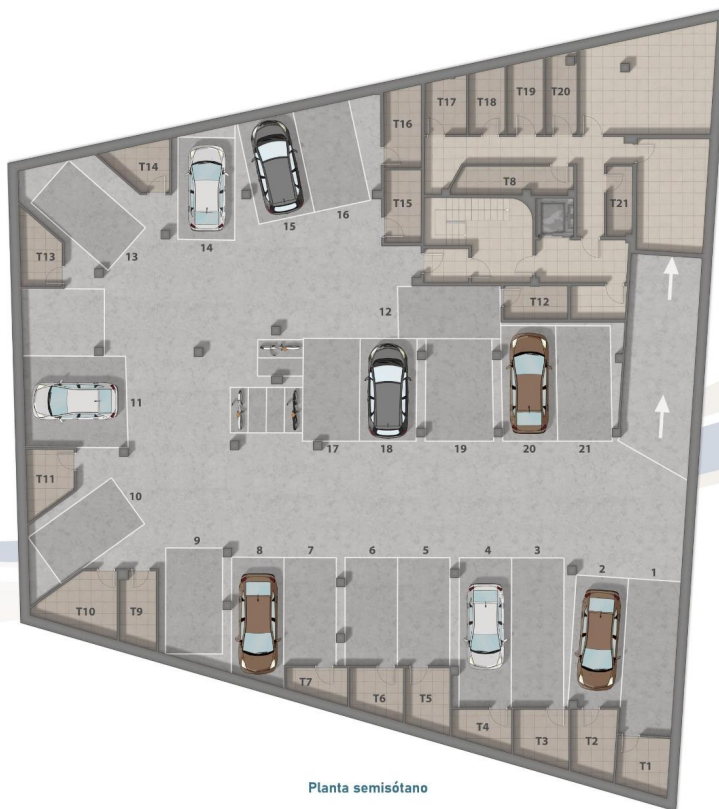

Planta semis6tano



Planta solarium

*"Experience our experience - Because you deserve the best"*